



General Description

Datalogic renews its range of industrial laser scanners introducing the **Dragon™** family: **Dragon™ Desk** and **Dragon™ Mobile**. Based on the same rugged and reliable mechanics of the well-established DLL6000 series, they have been completely renewed inside. Robustness and ergonomics, the main driver of our original project, remain unsurpassed: clearly audible beeper and bright "good read" LEDs for areas where noise levels are normally high; the aim mode, which helps point to the right code, has now been extended to the whole **Dragon™** family. Optical parts are completely suspended on shock absorbers and a careful choice of the body materials, such as the co-moulded rubber, protect the **Dragon™** from damage due to "falls".

New enhanced architecture, based on a M16 high-speed microprocessor, enables exceptional performance for promptness and reading speed of standard codes as well as the ability to read poorly printed and damaged codes. Puzzle Solver Technology™, a patent from Datalogic, adds further strength to the **Dragon™** powerful engine.

In all applications where mobility is a value, the new **Dragon™ M** represents the key to increase productivity and flexibility in the working area. **Dragon™ M** communicates through a low power, licence free radio in the 433 Mhz band (910 Mhz for USA version) and allows bi-directional communication between the base station and the host. **Dragon™ M** also includes a display and a 3 push-button keypad. Thanks to these features, the operator can receive information from the host, actively interact with the central system and visualise the code read. The cordless system offers scalable solutions to solve simple applications and complex projects.

Features

Dragon™ Desk

- > 2 meter drop resistance
- > 3 optics available
- > Man/machine interface: high tone beeper and strong illuminating LEDs

Dragon™ Mobile

- > Several models available:
 - With or without display
 - High Performance or Long Range optics system
 - 433MHz or 910MHz radio systems
- > Seamless roaming
- > Point-to-Point & Multipoint transmission
- > 100% compatible with STAR-System™

Applications

- > Work-in-progress control
- > Warehouse management
- > Shipping and receiving control
- > Cash & carry retail applications
- > Fork lifts

Specifications

MODELS

LIGHT SOURCE
MAX SCAN RATE
MAX RESOLUTION

PRINT CONTRAST RATIO (min)
READING ANGLE
READING INDICATORS
BAR CODES

PROGRAMMING METHOD

Manual
Automatic
Sm@rtSet™
INTERFACES
ENHANCED
FEATURES
CASE MATERIAL
AMBIENT LIGHT CONDITIONS
HUMIDITY
ENVIRONMENTAL PROTECTION

CRADLE

POWER SUPPLY
POWER CONSUMPTION
READING INDICATORS
DIMENSIONS without antenna
CASE MATERIAL
WEIGHT

MODELS

POWER SUPPLY
CONSUMPTION
OPERATING TEMPERATURE
STORAGE TEMPERATURE
DROP RESISTANCE
WEIGHT

DRAGON™ D & DRAGON™ M

VLD 630 - 680 nm (depending on the model)
35 +/- 5 scans/sec
0.08 mm: D101; 0.06 mm: D101: HD; 0.25 mm: D101 LR;
0.12 mm: M 101; 0.25 mm: M101 LR
15% D101, 40% D101 HD, D101 LR 15% M101 40% M101 LR
Skew: +/-60; Pitch: 5 to 55, -5 to -55; Tilt: +/-20
Laser ON, Good Read, Beeper, Good transmission (Dragon™ M only)
2/5 family, Code 39 (plus Code 32, Cip 39), EAN/UPC, EAN 128,
Code 128, Code 93, CODABAR, TELEPEN, PLESSEY, Code 49, Code MSI,
Code Delta IBM, Code 11, CODABLOCK, Code 16K, ISBN/ISSN, ISBT 128

Reading special bar codes
S/W commands through the RS232 serial port
Windows configuration program
RS232, Wedge, Pen emulation
Puzzle Solver™, data editing
and data concatenation
ABS and polycarbonate, plus co-moulded rubber
Immune to light exposure in offices/facilities, and direct exposure to sunlight
90% non condensing
Immune to water and dust

OM DRAGON™

9 to 28 Vdc
max. 8 W
Battery charging (red), Charge completed (green), Power/Data (yellow)
185 x 115 x 104 mm (7.28 X 4.52 X 4.09 in)
ABS
Approx. 600 g (21,1 oz)

DRAGON™ D

4 to 20 Vdc
250 mA @ 4 V; 170 mA @ 5 V; 40 mA @ 20 V
-10 to 50 °C (14 to 122 °F)
-20 to 50 °C (-4 to 140 °F)
Withstands repeated drops from 2 m onto a concrete surface
Approx. 270 g (9,53 oz)

MODELS

BATTERY TYPE

DISPLAY

KEYPAD

RECHARGE TIME
OPERATING
AUTONOMY

OPERATING TEMP.
STORAGE TEMP.
DROP RESISTANCE

WEIGHT

RADIO SPECIFICATIONS

RADIO FREQUENCY
BIT RATE
EFFECTIVE RADIATED
POWER
RADIO RANGE

MAX NR.
COEXISTING
SYSTEMS

DRAGON™ M

NiMh (3480 mWh) (All AA
NiCD and Alkaline batteries
can also be used)
Graphic with backlight,
32 x 96 dots, and font
dimension can be selected by
the user (with default selection
4 lines x 16 columns)
(M101/D model only)
Membrane keypad with 3 keys
(M101/D model only)
2 hours
Over 60,000 with NiMh
batteries
(Test mode: 100 reads/min)
-10 to 40 °C (14 to 122 °F)
-20 to 50 C (-4 to 122 F)
Withstands repeated drops
from 1,8 m (M101),
1,5 m (M101/D) onto a
concrete surface
Approx. 340 g (12 oz)

Accessories



STD1000

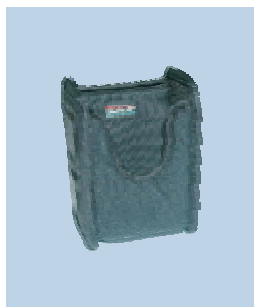

HLS1000

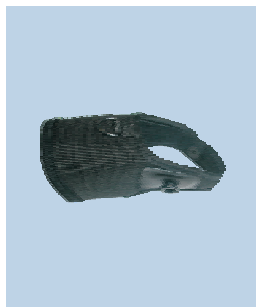

Protective case



OM - Dragon™

Stand

Robust and compact, the stand makes it possible to use the reader in a hand-free mode.

Desk/Wall Holder

It is designed to offer a robust and handy way to attach the readers to desktops, work-tables, forklift trucks, and other types of supports.

Protective case - Belt coupler

This permits the reader to be carried on a belt, when not in use, and protect it against drops.

OM Dragon™

The cradle functions both as a radio base station and a recharge base, providing RS232 and RS485 connection.

Reading Diagrams

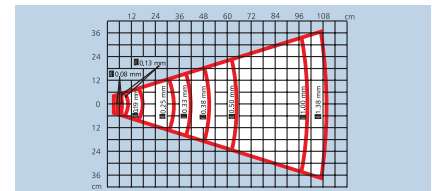

Dragon™ DIM101

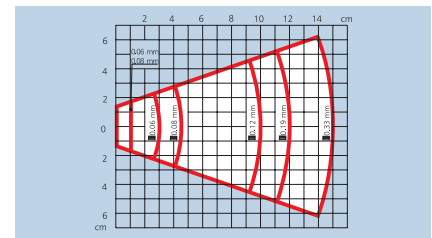

Dragon™ D101 High Density model

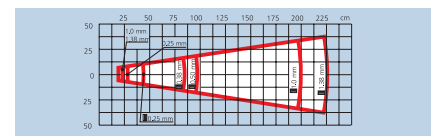

Dragon™ DIM101 Long Range model



Product and Company names and logos referenced may be either trademarks or registered trademarks of their respective companies. We reserve the right to make modifications and improvements.

